

METRIC

PLATE No
CONT No 2020-4075
WP No 4173-15-00



**HWY 417 FULL CLOSURE
 PRESTON STRUCTURE
 DETOUR ROUTING**

**SHEET
 16**

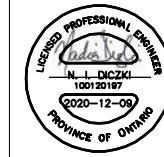

LEGEND

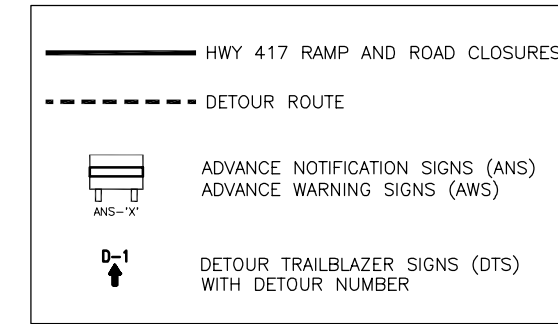

NOTES:

1. PLACEMENT OF TEMPORARY CONDITIONS SIGNAGE SHALL NOT OBSTRUCT MOTORISTS' VIEW OF EXISTING SIGNAGE.
2. MINIMUM SEPARATION BETWEEN ENGLISH AND FRENCH SIGNAGE SHALL BE 50m ON CITY STREETS AND 150m ON HIGHWAY 417.
3. ADVANCE NOTIFICATION SIGNS (ANS) TO BE INSTALLED 2 WEEKS PRIOR TO THE CLOSURE.
4. ADVANCE WARNING SIGNS (AWS) AND DETOUR TRAILBLAZER SIGNS (DTS) SHALL BE INSTALLED AND REMAIN IN PLACE DURING THE CLOSURE. TABS SHALL BE USED TO CHANGE SIGNS FROM ADVANCE NOTIFICATION TO ADVANCE WARNING.
5. HIGHWAY 417 FULL CLOSURE SHALL BE AS SPECIFIED ELSEWHERE IN THE CONTRACT.
6. CONTRACTOR SHALL CLOSE LANES ON CITY STREETS THAT LEAD TO CLOSED RAMPS AS DETAILED ELSEWHERE.
7. LYON N-W RAMP CLOSED FOR DURATION OF CONSTRUCTION, SIGNAGE FOR CLOSURE DETAILED ELSEWHERE.
8. SIGNAGE MAY REQUIRE COORDINATION WITH ADJACENT CONSTRUCTION ZONES. CONTRACTOR TO COORDINATE WITH CONTRACT ADMINISTRATOR.

ADVANCE NOTIFICATION SIGN MESSAGES

	ANS-1A (HWY 417 EB)	ANS-1B (HWY 417 EB ON-RAMPS)	ANS-2A (HWY 417 WB)	ANS-2B (HWY 417 WB ON-RAMPS)
ADVANCE NOTIFICATION – TWO WEEKS PRIOR TO FULL CLOSURE	417 EAST TO BE CLOSED CARLING – METCALFE DD MMM YY – DD MMM YY	ACCESS TO 417 EAST TO BE CLOSED CARLING – METCALFE DD MMM YY – DD MMM YY	417 WEST TO BE CLOSED BRONSON – PARKDALE DD MMM YY – DD MMM YY	ACCESS TO 417 WEST TO BE CLOSED O'CONNOR – PARKDALE DD MMM YY – DD MMM YY
ADVANCE WARNING – DURING FULL CLOSURE	417 EST SERA FERMÉE CARLING – METCALFE JJ MMM AA – JJ MMM AA	ACCÈS À LA 417 EST SERA FERMÉ CARLING – METCALFE JJ MMM AA – JJ MMM AA	417 OUEST SERA FERMÉE BRONSON – PARKDALE JJ MMM AA – JJ MMM AA	ACCÈS À LA 417 OUEST SERA FERMÉ O'CONNOR – PARKDALE JJ MMM AA – JJ MMM AA

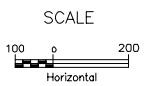
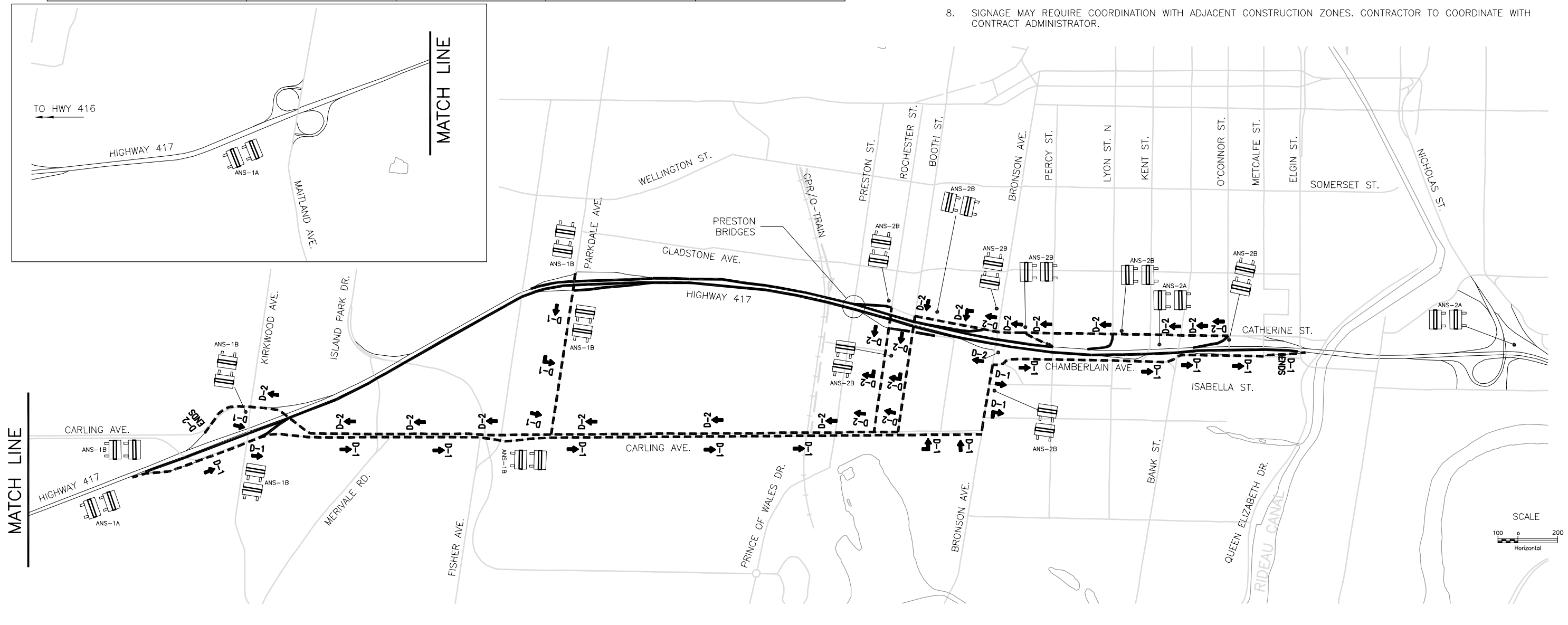

FILE LOCATION: \\G00TT1\G00DATA1\03416024 HWY 417 MID-TOWN BRIDGES\CURRENT\ SHEETS\
 DRAWING NAME: 016--DETOUR PRESTON.DWG
 DRAWN BY: S.C.
 MODIFIED: 20/11/20
 14:26:15

MINISTRY OF TRANSPORTATION, ONTARIO
 PR-0-707 08-05